

MX 2000 DSC

Parts list	Code	List \$ Price
Motor brushes (2)	0504	14,86
Ball bearing	0601	14,86
Waterproof seal	0607	19,39
Squeezing washer	0726	2,09
Wall bracket	0862	21,76
Strain relief 230 V	0950	2,60
Strain relief 115 V	0950.1	2,60
Warning label	1017	5,23
Dynamic label	1021	12,96
ID label 115 V	1097	5,36
ID label 230 V	1099.15	5,36
Control lever	2001	10,77
Safety control lever	2002	6,40
230 V electronic circuit board	2003DSC	253,93
115 V electronic circuit board	2003.1DSC	253,93
Half handle (no button)	2004	55,81
Half handle (button side)	2005	55,81
Motor housing brush holder	2006DSC	77,91
Complete foot assembly	2007	400,09
Foot assembly	2009	278,99
Stator 230 V	2011DSC	214,79
Stator 115 V	2011.1DSC	214,79
Power cord 230 V	2012	24,53
Power cord 115 V	2012.1	29,54
Power cord (English)	2012.2	54,07
Power cord (Australian)	2012.3	59,18
Variable speed control button	2021	4,22
Complete handle 230 V	2060	236,98
Complete handle 115 V	2060.1	236,98
Sensoring washer (washers, magnets, screws, small brace)	2061	18,30
Spacer screws (4)	7903	4,82
Emulsifying blade	7910	62,93
Lower bearing assembly	7916	36,02
Spacer cutter blade	7917	39,36
Fan	7933	9,47
Rotor 115 V	9008.11DSC	236,90
Rotor 230 V	9008.12DSC	236,90
Handle screws (4)	9014	0,69
Motor field screws (2)	9023	3,92
Motor ball bearing sleeve	9025	4,54
Spacer rods (4)	9026	16,76
Carbon brush wires (2) (230 V)	9043	9,89
Fitted shaft	9131	77,91
Carbon brush wires (2) (115 V)	9143	9,89
Shaft, lower ball bearing & cutter assembly	9164	137,84
Lower bearing screws (3)	9902	1,30
Rubber button cap	45710	3,22

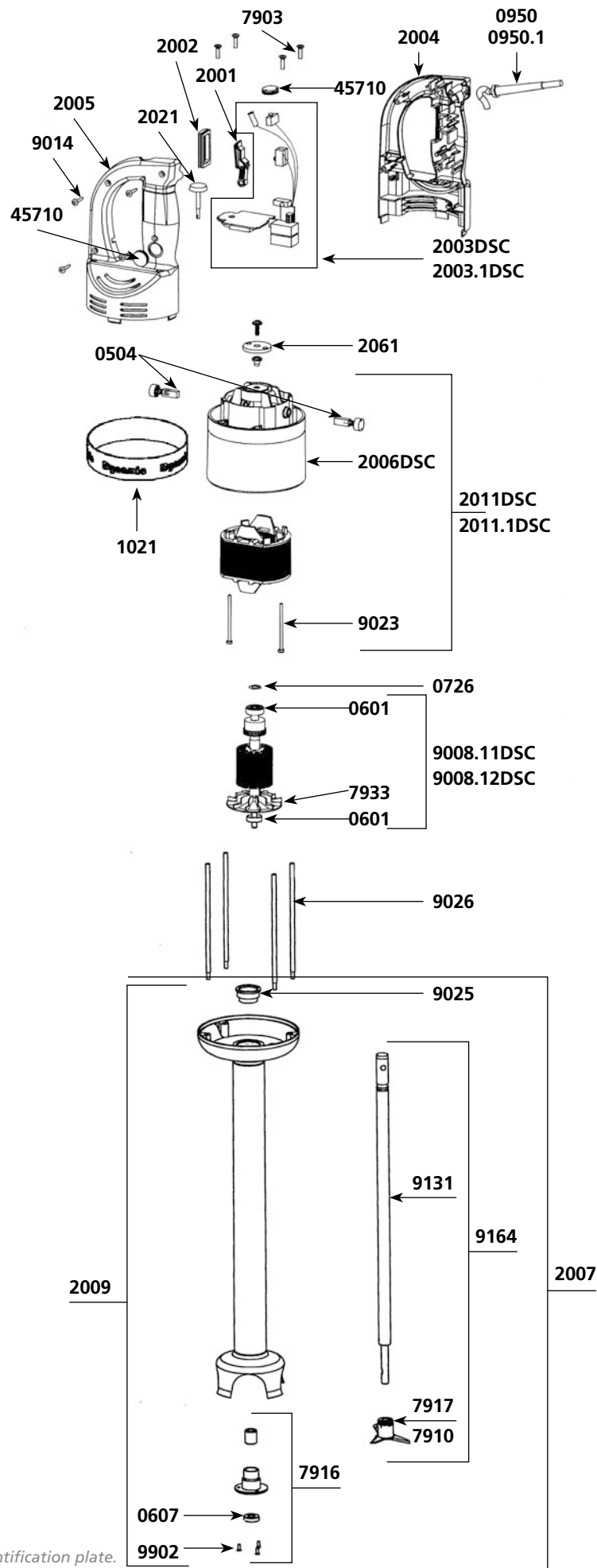

IMPORTANT : Each spare part order must include the type and the number of the product which appears on the identification plate.