



5599 Highway 31 West  
Portland, TN 37148  
(800) 222-4393

# P-108

Pg.1 . TITLE PAGE

Pg.3 . P-108 BOM

Pg.2 . P-108 EXPLODED

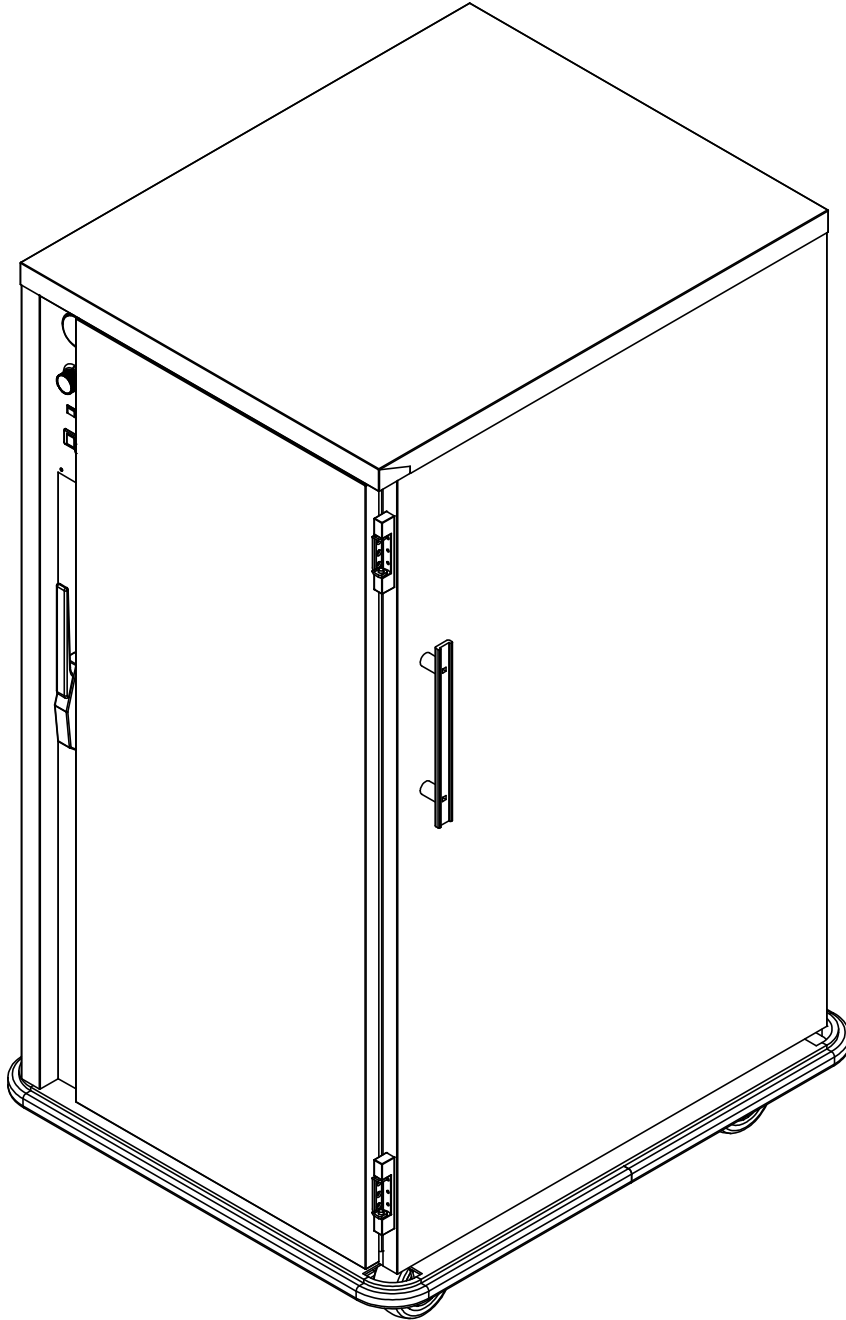

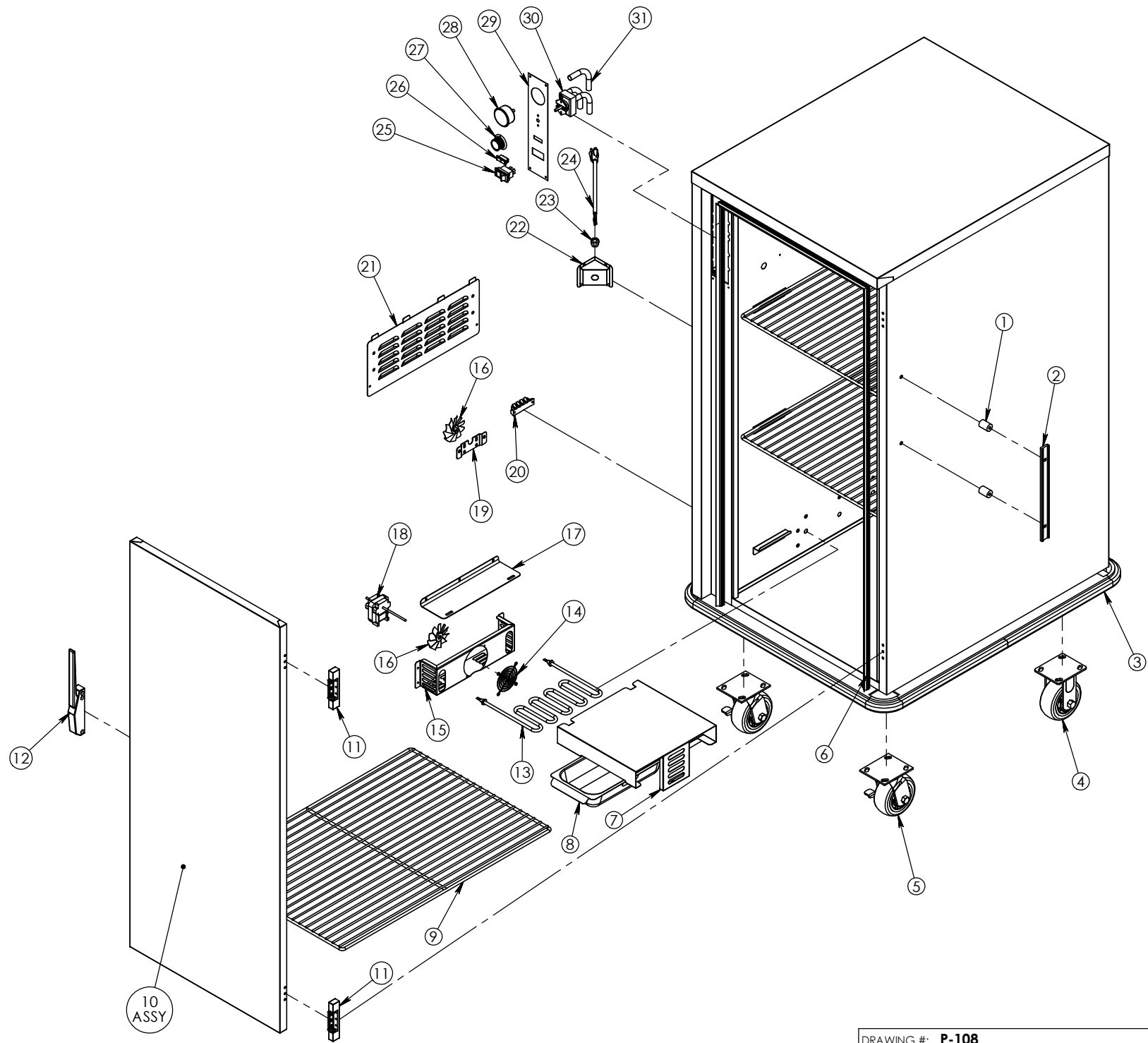

DRAWING #: <b>P-108</b>	
DESCRIPTION: <b>BANQUET CABINET HUMI-TEMP</b>	
DRAWN BY: DP	LAST SAVED BY: dplodzien

ITEM NO.	QTY.	PART NO.	DESCRIPTION
1	4	<a href="#">SPCR125X.330</a>	HANDLE SPACERS FOR HDL 21 AND 12.
2	2	HDL-125-AL	HANDLE PUSH ALUMINUM 12.5" LONG
3	1	Z-200-1092	BUMPER P-108
4	2	CSTR 52-R-PPF	CASTER 5" RIGID EZ ROLL POLY
5	2	CSTR 52-SB-PPF	CASTER 5" SWIVEL BRAKE EZ ROLL POLY
6	1	GSKT-D-54-563X23-250	SILICONE DR GASKET D 54.5625X23.25
7	1	<a href="#">58408</a>	UHS-12 HEAT SHIELD USE WITH H20 PAN
8	1	<a href="#">WATER-PAN-3RD-WHDL</a>	WATER PAN 2.5" X6.75 X
9	3	SHLF-P90	SHELF 22.25x33"
10	1	Z-301-4697	P-108 DOOR ASSY EDG/EDG RH
11	2	<a href="#">HNG-214</a>	DOOR HINGE EDGEMOUNT .875"
12	1	<a href="#">LTH-DR</a>	DOOR LATCH EDGEMOUNT STYLE CHROME
13	1	<a href="#">EL1250-120-HT</a>	ELEMENT 1250 WATT 120 VOLT 8" HT
14	1	GRD FAN	FAN GUARD
15	1	<a href="#">4011</a>	HUMITEMP BLOWER HOUSING
16	2	BLD FAN AL	FAN BLADE 3" ALUMINUM
17	1	<a href="#">4041</a>	HUMITEMP BLOWER LID
18	1	MTR JK120 92	MOTOR DUAL SHAFTED 120 VOLT
19	1	<a href="#">80610</a>	BRACKET MOTOR MNT FOR BAY MTR
20	1	TRM 4QC	TERMINAL BLOCK 4QC
21	1	53454	HUMITEMP LOUVER PANEL W/TABS
22	1	69729	HUMI TRI-CORD BRCKET DD .672X .750
23	1	BSH STRN 3	STRAIN RELIEF FOR 15 AMP CORD
24	1	<a href="#">CRDSET10-115</a>	CORD 12' 115V 5-15P 14GA 3WR 15AMP
25	1	SWH RCK E1	SWITCH NON-LT ROCKER 125/250V 20AMP
26	1	<a href="#">LT PLT A-G</a>	INDICATOR LIGHT AMBER GREEN 125V
27	1	KNB H6	KNOB WITH ARROW
28	1	T-METER H1	THERMOMETER 100/220F
29	1	<a href="#">CNTRL-PNL-HUMI-TEMP-AL</a>	ALUM PANEL FOR HUMI-TEMP
30	1	T-STAT HT	THERMOMSTAT HEAT CONTRL 90-190 36"
31	1	<a href="#">SLV-ACRYLIC-WHITE-7-16 @ 25"</a>	SLEEVING ACRYLIC 7/16 ID WHITE FA1

DRAWING #: **P-108**

DESCRIPTION: **BANQUET CABINET HUMI-TEMP**

DRAWN BY: DP

LAST SAVED BY: dplodzien