



5599 Highway 31 West
Portland, TN 37148
(615) 325-2774

P-144-2

Pg.1 . TITLE PAGE

Pg.3 . P-144-2 BOM

Pg.2 . P-144-2 EXPLODED

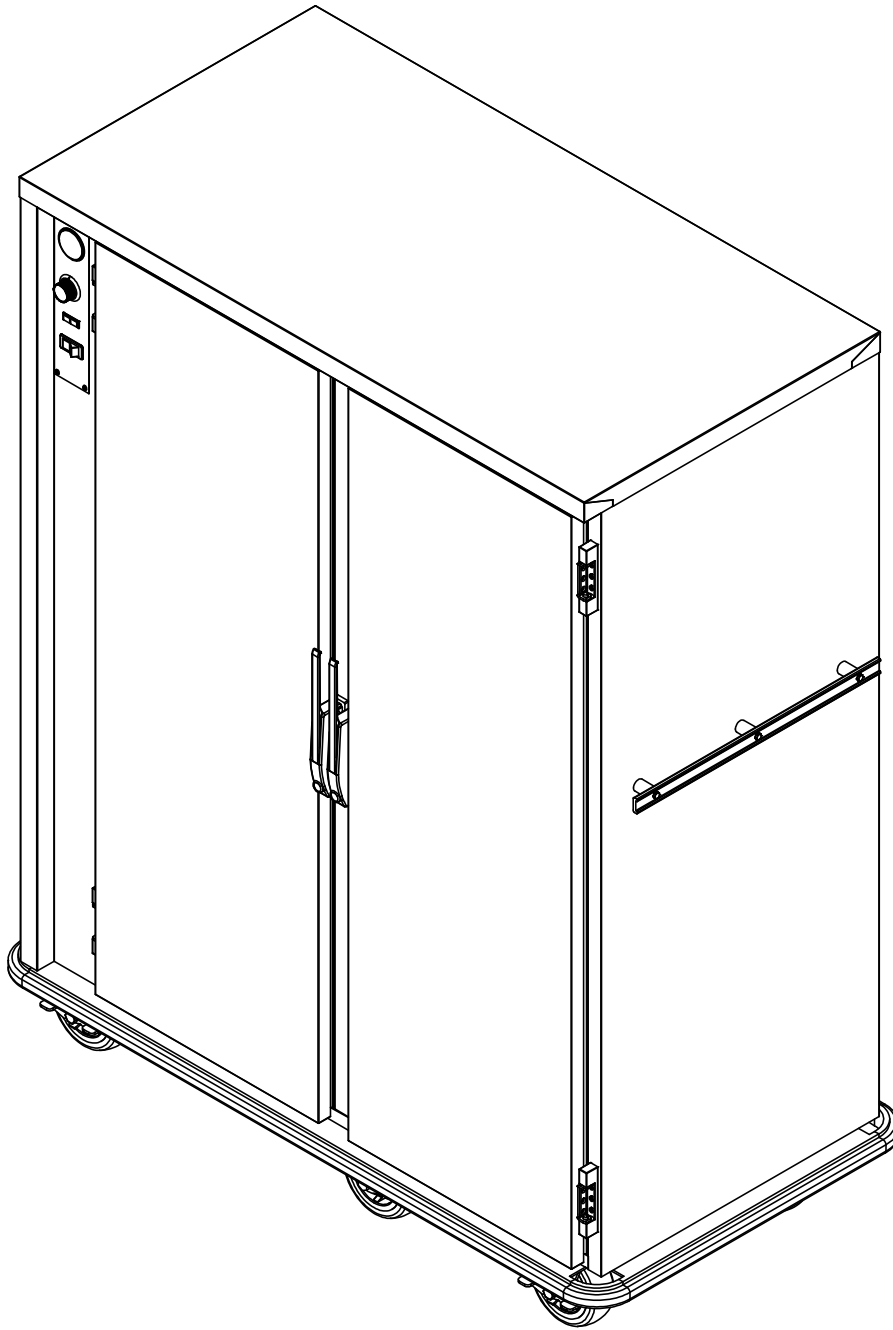

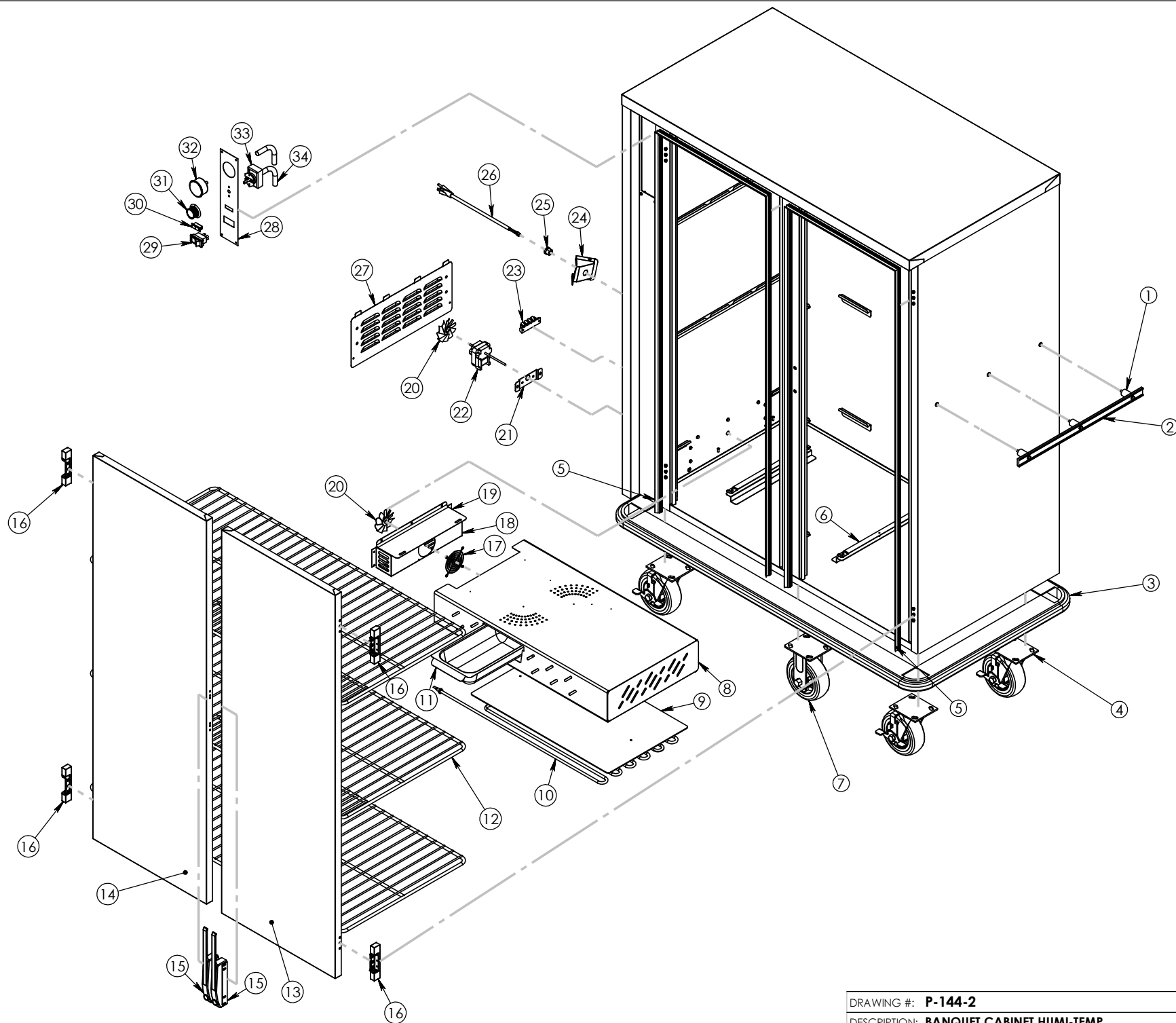

DRAWING #: P-144-2	
DESCRIPTION: BANQUET CABINET HUMI-TEMP	
DRAWN BY: DP	LAST SAVED BY: dplodzien

ITEM NO.	QTY.	PART NO.	DESCRIPTION
1	6	SPCR125X.330	SPACER PUSH HDL 1.25X5/16
2	2	HDL-215-AL	HANDLE PUSH AL 21.5
3	1	Z-200-1002	BUMPER
4	4	CSTR 62-SB-PPF	CASTER 6X2" EZ ROLL SWIVL POLY BLUE
5	2	GSKT-D-57-250X19-375	SILICONE DR GASKET D 57.250X19.375
6	1	5958	ELEMENT BRACKET STRAP
7	2	CSTR 62-R-PPF	CASTER 6X2" EZ ROLL RIGID POLY BLUE
8	1	50001	WATER PAN TUNNEL
9	1	50300	ALUM HTNG ELEMENT CVR
10	1	EL1600-120HT-XL-28	HEAT ELEMT 1600W120V HUMI
11	1	WATER-PAN-3RD-WHDL	WATER PAN 2.5" X6.75 X
12	3	SHLF-P120	SHELF 22.25X44.25"
13	1	Z-301-3889 (INCLUDES 15&16)	DOOR ASSY EDG/MAG RH
14	1	Z-301-3890 (INCLUDES 15&16)	DOOR ASSY EDG/MAG LH
15	1	LTH MAG	DOOR LATCH EDGEMOUNT CHROME MAGNTIC
16	4	HNG-214	DOOR HINGE EDGEMOUNT .875"
17	2	GRD FAN	FAN GUARD
18	1	5345	HUMITEMP BLOWER HSING
19	1	4041	HUMITEMP BLOWER LID
20	2	BLD FAN AL	BLADE FAN AL 3IN 1875-0
21	1	4009	BRACKET MOTOR MNT MTR JK120 92
22	1	MTR JK120 92	MOTOR, 115V
23	1	TRM 4QC	TERMINAL BLOCK 4QC
24	1	69729	HUMI TRI-CORD BRCKET DD .672X .750
25	1	BSH STRN 3	STRAIN RELIEF FOR 15 AMP CORD
26	1	CRDSET10-115	CORD 12' 115V 5-15P 14GA 3WR 15AMP
27	1	53454	HUMITEMP LOUVER PANEL W/TABS
28	1	CNTRL-PNL-HUMI-TEMP-AL	ALUM PANEL FOR HUMI-TEMP
29	1	SWH RCK E1	SWITCH NON-LT ROCKER 125/250V 20AMP
30	1	LT PLT A-G	INDICATOR LIGHT AMBER GREEN 125V
31	1	KNB H6	KNOB WITH ARROW
32	1	T-METER H1	THERMOMETER 100/220F
33	1	T-STAT H1	THERMOMSTAT HEAT CONTRL 90-190 36"
34	1	SLV-ACRYLIC-WHITE-7-16 @ 25"	SLEEVING ACRYLIC 7/16 ID WHITE FA1

DRAWING #: **P-144-2**

DESCRIPTION: **BANQUET CABINET HUMI-TEMP**

DRAWN BY: DP

LAST SAVED BY: dplodzien