

**MODEL:**

**PS-1220-10**

**Parts Manual**

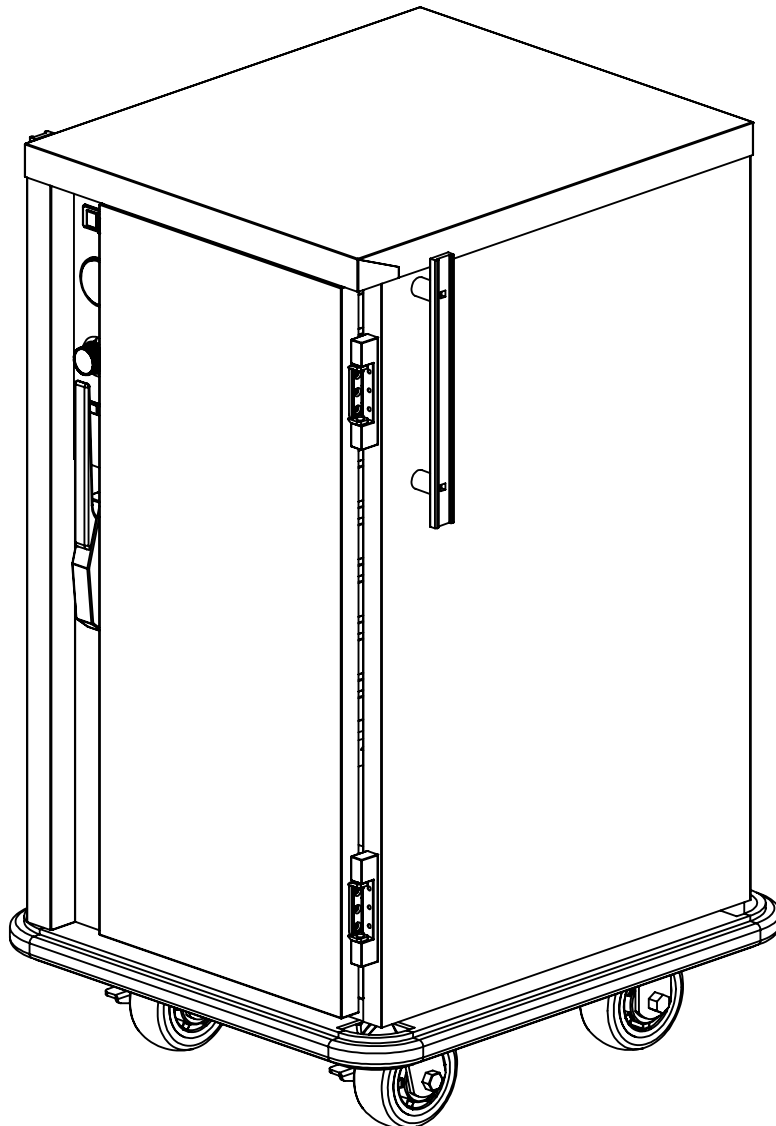

### CONTROL PANEL OPTIONS

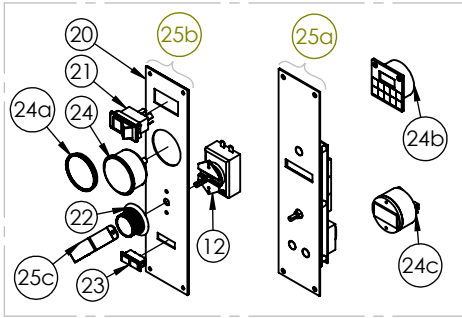

### LATCH OPTIONS

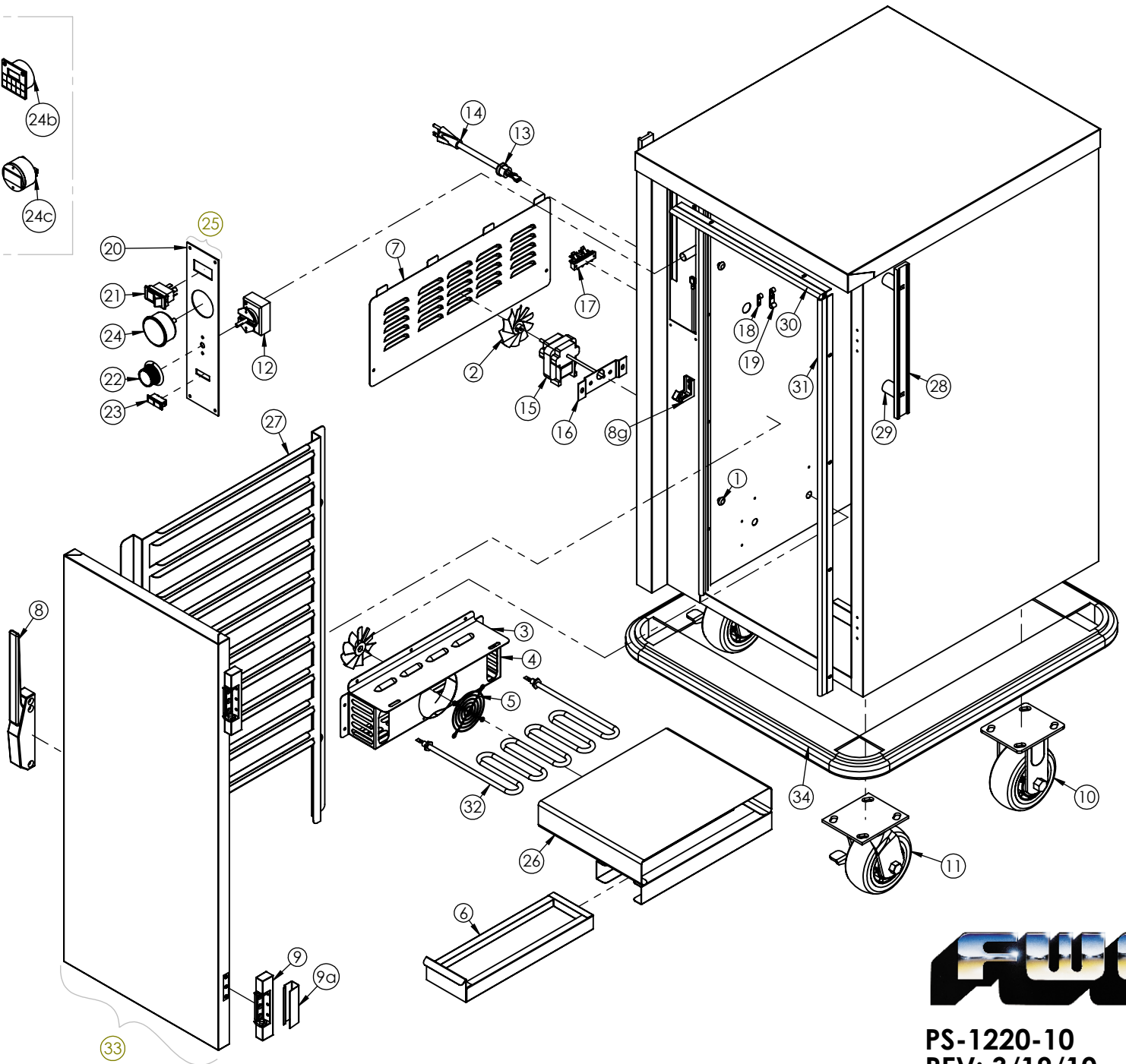
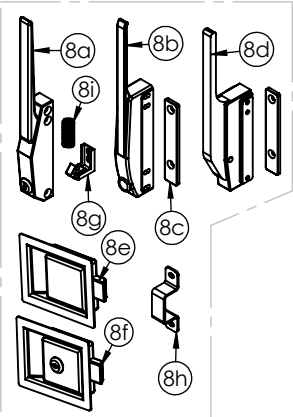

PS-1220-10  
REV: 3/19/10

| PS-1220-10 PARTS LIST                             |      |                        |                                                                   |                                          |                            |
|---------------------------------------------------|------|------------------------|-------------------------------------------------------------------|------------------------------------------|----------------------------|
| **NOTE: CALL MANUFACTURER IF PART IS NOT LISTED** |      |                        |                                                                   | *ELEMENT AND CORD OPTIONS FOR PS-1220-10 |                            |
| ITEM NO.                                          | QTY. | PART NO.               | DESCRIPTION                                                       | 120V ELEMENT-EL1250-120-HT               | 120V CORD 15A-CRDSET10/115 |
| 1                                                 | 8    | B1/4-20X12CS           | BOLT CARG 1/4-20X.7518-8S                                         | 120V UPGRADE-EL1500-120-HT               | 120V CORD 15A-CRDSET10/115 |
| 2                                                 | 2    | BLD FAN AL             | BLADE FAN AL 3IN 1875-0 (120V)                                    |                                          |                            |
| 3                                                 | 1    | 4041                   | HUMITEMP BLOWER LID                                               | 220V ELEMENT-EL1250-220-HT               | 220V CORD 15A-CRDSET10/220 |
| 4                                                 | 1    | 4011                   | HUMITEMP BLOWER HOUSING                                           | 220V UPGRADE-EL1500-220-HT               | 220V CORD 15A-CRDSET10/220 |
| 5                                                 | 1    | GRD FAN                | GUARD FAN HUMI-TEMP UNITS                                         |                                          |                            |
| 6                                                 | 1    | 50907                  | HUMIDIFIER PAN, 4IN WIDE                                          |                                          |                            |
| 7                                                 | 1    | 53454                  | HUMITEMP LOUVER PANEL W/TABS                                      |                                          |                            |
| 8                                                 | 1    | LTH-DR                 | EDGEMOUNTED DOOR LATCH/CHROME (STANDARD) INCLUDES ITEM 8g         |                                          |                            |
| 8a                                                | 1    | LTH-DR LK              | EDGEMOUNTED DOOR LATCH/CHROME WITH LOCK (OPTION) INCLUDES 8g      |                                          |                            |
| 8b                                                | 1    | LTH MAG                | MAGNETIC CHROME LATCH (OPTION) INCLUDES 8c                        |                                          |                            |
| 8c                                                | 1    | LTH-DR-MAG-RH-STRIKE   | LATCH OFFSET COMPOSITE, BLACK STRIKE                              |                                          |                            |
| 8d                                                | 1    | LTH DR MAG-RH          | MAGNETIC LATCH OFFSET COMPOSITE, BLACK (OPTION) INCLUDES 8c       | *OTHER DOOR OPTIONS AVAILABLE -          |                            |
| 8e                                                | 1    | LTH PDL-STD 50         | PADDLE LATCH 4.000 X 5.000 1/2IN STD (OPTION)                     | CALL FACTORY FOR IDENTIFICATION          |                            |
| 8f                                                | 1    | LTH PDL LK-STD 50      | PADDLE LARGE SS WL 30250 (OPTION)                                 |                                          |                            |
| 8g                                                | 1    | STK LTH 1              | STRIKE USED FOR EDGEMOUNTED DOOR LATCH                            |                                          |                            |
| 8h                                                | 1    | 5160                   | STRIKE USED FOR LOCKING AND NON-LOCKING PADDLE LATCHES            |                                          |                            |
| 8i                                                | 1    | LTH DR SPG             | SPRING USED FOR EDGEMOUNT LATCH                                   |                                          |                            |
| 9                                                 | 2    | HNG-214                | HINGE CAB DR CRM .875                                             |                                          |                            |
| 9a                                                | 2    | HNG 217 COVER          | HINGE COVER (OPTION)                                              |                                          |                            |
| 10                                                | 2    | CSTR 5 R-2             | CASTER HEAVY DUTY STANDARD 5" RIGID                               |                                          |                            |
| 11                                                | 2    | CSTR 5 SB-2            | CASTER HEAVY DUTY STANDARD 5" SWIVL                               |                                          |                            |
| 12                                                | 1    | T-STAT H1              | THERMOSTAT CAB 90-190 36IN                                        |                                          |                            |
| 13                                                | 1    | BSH STRN 3             | STRAIN-RELIEF BLK 6N3-4                                           |                                          |                            |
| 14*                                               | 1    | CRDSET-10/115          | CORDSET 10FEET 115V (STANDARD)- REF ELEMENT AND CORD OPTIONS      |                                          |                            |
| 15                                                | 1    | MTR JK120 92           | MOTOR, 120V (VERIFY VOLTAGE)                                      |                                          |                            |
| 15a                                               | 1    | MTR JK 220 93          | MOTOR, 220V (VERIFY VOLTAGE)                                      |                                          |                            |
| 16                                                | 1    | 4009                   | MOTOR MOUNT BRACKET                                               |                                          |                            |
| 17                                                | 1    | TRM 3QC                | TERMINAL BLOCK 3 QC TERM                                          |                                          |                            |
| 18                                                | 2    | CLP-AL1-4              | CLAMP ALUMINUM .250 WIDE                                          |                                          |                            |
| 19                                                | 1    | CLP-AL3-8              | CLAMP ALUMINUM .375 WIDE                                          |                                          |                            |
| 20                                                | 1    | CNTRL-PNL-HUMI-TEMP-AL | HUMITEMP CONTROL PANEL BLANK X 2                                  |                                          |                            |
| 21                                                | 1    | SWH RCK E1             | ROCKING SWITCH NON-LT 20A,125V                                    |                                          |                            |
| 22                                                | 1    | KNB H6                 | KNOB CONTROL ALUMINUM SKIRT SILVER                                |                                          |                            |
| 23                                                | 1    | LT-PLT A/G             | LIGHT AMBER/GREEN 125V                                            |                                          |                            |
| 24                                                | 1    | T-METER H1             | THERMOMETER 100/220F (STANDARD)                                   |                                          |                            |
| 24a                                               | 1    | T-METER-LENS-COVER     | THERMOMETER 100/400 LENS (OPTION)                                 |                                          |                            |
| 24b                                               | 1    | T-MTR-DIG-40F-300F     | SOLAR POWER DIGITAL THERMOMETER (OPTION)                          |                                          |                            |
| 24c                                               | 1    | T-MTR DIG F            | DIGITAL THERMOMETER (OPTION)                                      |                                          |                            |
| 25                                                | 1    | Z-600-1014             | HUMITEMP CONTROL ASSY. INCLUDES ITEMS 20,21,22,23,24 (STANDARD)   |                                          |                            |
| 25a                                               | 1    | CNTRL HUMI-TEMP        | DIGITAL HUMI-TEMP CNTRL (OPTION)                                  |                                          |                            |
| 25b                                               | 1    | Z-600-1460             | HUMITEMP CONTROL ASSY. INCLUDES ITEMS 20,21,22,23,24,25c (OPTION) |                                          |                            |
| 25c                                               | 1    | 5561                   | THERMOSTAT RETENTION STRAP HDM                                    |                                          |                            |
| 26                                                | 1    | 5190                   | HUMITEMP TUNNEL 12                                                |                                          |                            |
| 27                                                | 2    | 4007                   | PS-1220-10 RACK                                                   |                                          |                            |
| 28                                                | 2    | HDL 12.5 AL            | ALUMINUM HANDLE 12 1/2 LONG                                       |                                          |                            |
| 29                                                | 4    | SPCR 125X.330          | SPACER PUSH HDL 1.25X5/16                                         |                                          |                            |
| 30                                                | 1    | Z-700-1018             | GASKET AND HOLDER ASSY. 22,75 INCH                                |                                          |                            |
| 31                                                | 2    | Z-700-1037             | GASKET AND HOLDER ASSY. 47,5 INCH                                 |                                          |                            |
| 32*                                               | 1    | EL1250-120HT           | HEAT ELEMENT 1250W120V HUMI (STANDARD) (VERIFY VOLTAGE)           |                                          |                            |
| 33                                                | 1    | Z-301-1082             | PS-1220-10 DOOR ASSY. INCLUDES ITEM NO. 8, 9                      |                                          |                            |
| 34                                                | 1    | Z-200-1058             | BUMPER ASSY. PS-1220-10                                           |                                          |                            |