

**Combination**

**Models with**

**Mixer and Whisk**

**Attachment**

**Diagram n°1**

Index PDF	Référence	Designation commerciale	Tarif
1	29660	MPC350 BLOCK MOTOR USA	0.00 USD
2	89634	MP NSF PROTECTIVE HOSE	13.50 USD
3	89662	MP / CMP DISMOUNT TOOL	34.70 USD
4	89630	MPC WALL SUPPORT	43.90 USD
5	89541	MPC/CMP 120V POWER CORD+SCREW+CAP SCREW	45.20 USD
6	89534	HANDLE (L+R) + SCREW + CAP SCREW MP	53.50 USD
7	89533	WATERPROOF NESS + SCREW + CAP SCREW KIT	16.00 USD
8	89536	BOUTON VARIATEUR MP/CMP+SCREW+CAP SCREW	16.70 USD
9	89508	VENT COVER (x2)	11.00 USD
10	89407	MPC 120V CIRC BOARD+SCREW+CAP SCREW	134.30 USD
11	89650	MP WHIP BOX	347.60 USD
12	89553	MP WHIPS KIT (x2)	194.90 USD
13	89544	PIGNONS RLT BAG BF MP+SCREW+CAP SCREW	193.50 USD
14	89379	MP/CMP BF UPPER BODY	43.00 USD
15	89385	PLATE+SCREW+CAP SCREW	92.40 USD
16	89387	MP BF ALU LOWER BODY	63.10 USD
17	89545	BF SEAL WASHER KIT+SCREW+CAP SCREW KIT	16.40 USD
18	89389	BF SCREW+CAP SCREW	18.20 USD
19	89552	MP/CMP WHIP EJECTOR	12.30 USD
20	89530	MP / CMP KNOBS KIT + SCREW + CAP SCREW	27.20 USD
21	89531	MP/CMP COMMAND ARM KIT +SCREW+CAP SCREW	52.80 USD
22	89621	MP SCREW M4x105 (x4)	5.10 USD
23	89532	MP / CMP HANDLE SCREW (x4)	12.20 USD
24	89409	MP C 120V ELECT WIRING+SCREW+CAP SCREW	29.50 USD
25	89582	MPC350 FERRULE	21.90 USD
26	89574	MPC MAGNET VENTILATOR	13.50 USD

**robot coupe®**

## Combination

### Models with

### Mixer and Whisk

### Attachment

27	89571	MP AIR DUCT	7.00 USD
28	89613	MP SELF REST	2.70 USD
29	89559	MP A 120V MOTOR	407.40 USD
30	89569	MP VENTILATOR PIPE	6.80 USD
31	89469	MP 120V BRUSHES KIT (x2)	16.40 USD
32	89519	MP450 120V INDUCED CIRC	149.60 USD
33	89507	MP MOTEUR BEARING	36.90 USD
34	89636	ADHESIF SECURED LABEL	2.70 USD
35	89633	MPC ALUMINIUM CASING	63.50 USD
36	89632	MPC DRIVING HUB	4.10 USD

## Diagram n°1

Determine the series of the tube & end bell to order some parts (see table below)

Déterminer la version du tube & de la cloche pour commander certaines pièces (voir tableau ci-dessous)

	<i>Original version : Tube &amp; end bell</i> Version origine : Tube & cloche	<i>Tube original series &amp; end bell series A</i> Tube version origine & cloche version A	<i>Tube series A &amp; end bell original series</i> Tube version A & cloche version d'origine	<i>Tube series A &amp; end bell series A</i> Tube version A & cloche version A
<b>B</b>	8	8		26
<b>C</b>	9	27		27
<b>D</b>	20a	21		21

**Original series : Tube & end bell**  
Version d'origine : Tube & cloche

**Series A : Tube & Stainless Steel end bell**  
Version A : Tube & cloche INOX

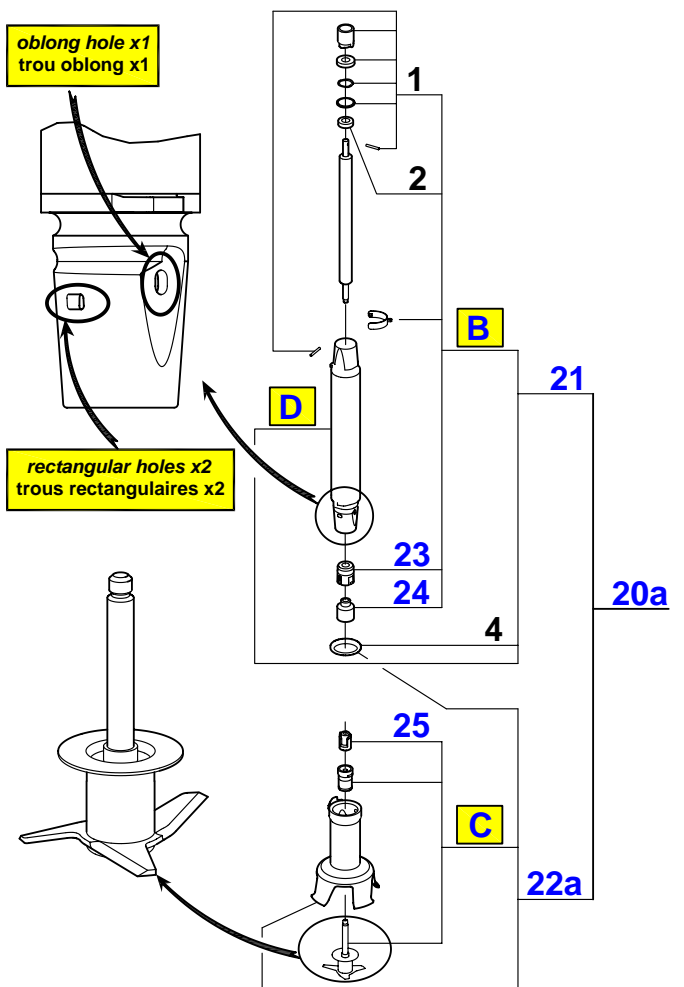
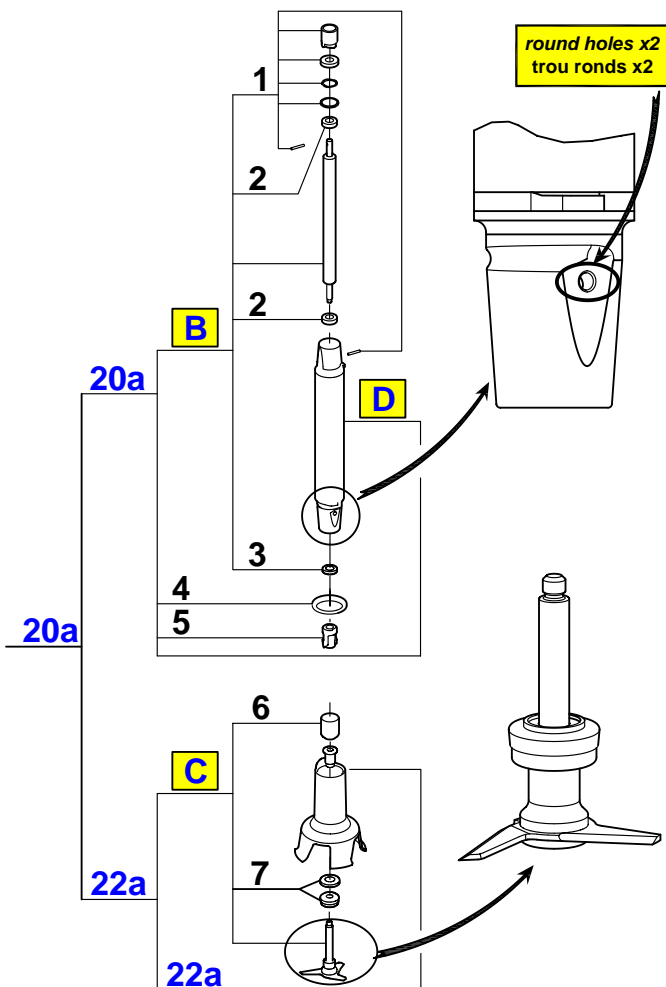

**WARNING** : All indexes followed by the letter a are replaced by series A parts or assemblies  
**ATTENTION** : Tous les index suivis de la lettre a sont des pièces ou ensemble remplacés par la version A

**Combination****Models with****Mixer and Whisk****Attachment****Diagram n°2**

Index PDF	Référence	Designation commerciale	Tarif
1	89643	MPC / CMP / CMPC FOOT KIT	24.50 USD
2	89645	BEARING 60x21x5	10.50 USD
3	89646	SEAL 8x18x5	10.50 USD
4	89628	MP / CMP FOOT SEAL	7.50 USD
5	89627	MP/CMP DRIVING HUB	29.50 USD
6	89626	MP/CMP DRIVING FRAME	29.30 USD
7	89642	SEAL RING	25.50 USD
8	29548	Drive Shaft Assy (MP350 COMBI)	130.40 USD
9	89503	MP450 BLADE	109.40 USD
20a	39354	MPC350A COMPLETE FOOT	778.00 USD
21	39452	MPC350A FOOT	218.40 USD
22a	39335	MP450 A BELL COVER	247.90 USD
23	39334	MPA FOOT BEARING RACE	36.70 USD
24	89624	STAINLESS STEEL DRIVING FRAME	29.50 USD
25	89625	MPA DRIVING HUB	24.10 USD
26	39352	MPC350 A DRIVING SHAFT	147.60 USD
27	39337	MP450 A BLADE	105.50 USD